

Brush Nickel (Finish ID : 3)

RUBY EDGE PULL HANDLE

Item Code	Size (mm & Inches)	Material	Size (Inches)				Fig.
			A	B	C	D	
1 PL.646.16.XX	16mm (0.63")	Brass	1.26	0.75	0.63	1.54	1
2 PL.646.1.5".XX	38mm (1.5")	Brass	2.5	0.75	1.5	1.54	1
3 PL.646.50.XX	50mm (1.96")	Brass	2.99	0.75	1.97	1.54	1
4 PL.646.76.XX	76mm (2.99")	Brass	4	0.75	2.99	1.54	1
5 PL.646.96.XX	96mm (3.78")	Brass	4.72	0.75	3.78	1.54	1
6 PL.646.128.XX	128mm (5.04")	Brass	6	0.75	5.04	1.54	1
7 PL.646.160.XX	160mm (6.3")	Brass	7.24	0.75	6.3	1.54	1
8 PL.646.11.125".XX	282.6mm (11.125")	Brass	12.07	0.75	11.13	1.54	1
9 PL.646.7".XX	177.8mm (7")	Brass	8	0.75	7	1.54	1
10 PL.646.8".XX	203.2mm (8")	Brass	9	0.75	8	1.54	1

"XX" in item code denotes Finish ID.

This product is Supplied with M4x25mm screws.
This product is Supplied with STC Screw Flat Head 6x13mm

Item Code	Size (mm & Inches)	Material	Size (Inches)				Fig.	
			A	B	C	D		
11	PL.646.9".XX	228.6mm (9")	Brass	10	0.75	9	1.54	1
12	PL.646.10".XX	254mm (10")	Brass	11	0.75	10	1.54	1
13	PL.646.12".XX	304.8mm (12")	Brass	13	0.75	12	1.54	1
14	PL.646.15".XX	381mm (15")	Brass	16	0.75	15	1.54	1
15	PL.646.18".XX	457.2mm (18")	Brass	19	0.75	18	1.54	1
16	PL.646.19".XX	482.6mm (19")	Brass	20	0.75	19	1.54	1
17	PL.646.24".XX	609.6mm (24")	Brass	25	0.75	24	1.54	1
18	PL.646.903.XX	903mm (35.55")	Brass	36.55	0.75	35.55	1.54	1

"XX" in item code denotes Finish ID.

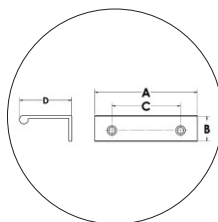
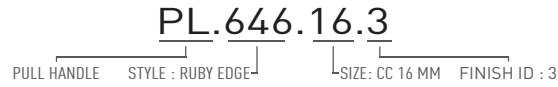

FIG. 1

This product is Supplied with M4x25mm screws.
This product is Supplied with STC Screw Flat Head 6x13mm

How to Order



Ruby Edge Pull Handle Finish Options

Base Material : Brass	Standard Finishes (2-3 Weeks Delivery)					
 Bright Chrome (Finish ID:2)	 Brush Nickel (Finish ID:3)	 Aged Brass (Finish ID:4)	 Oil Rubbed Bronze (Finish ID:5)	 Unlacquered Polished Brass (Finish ID:7U)	 Polished Nickel (Finish ID:8)	 Satin Brass (Finish ID:13)
Base Material : Brass	Custom Finishes (3-4 Weeks Delivery)*					
 Lacquered Polished Brass (Finish ID:7L)	 Antique Copper (Finish ID:15)	 Matte Black (Finish ID:19)	 Satin Chrome (Finish ID:24)	 Satin Copper (Finish ID:58)	 Graphite (Finish ID:61)	 Titanium (Finish ID:79)
 Brush Chrome (Finish ID:95)						

- Custom finishes cannot be returned or refunded. We are unable to accept cancellations for custom finish order unless within 48 hours of the order being placed.
- We have uniform pricing for all non-hammered finishes listed above as long as base material and size is same.
- Contact us for customized finishes, refer pages F1, F2, F3 & F4 for finish glossary.
- Backplate options refer page DBP1-1 to DBP2-1.