



Aged Brass (Finish ID:4)

HEATHCOTE HOOK

Item Code	Size (mm & Inches)	Material	Size (Inches)				Fig.
			A	B	C	D	
1 HK.1048.64.5.XX	64.5mm (2.54")	Brass	2.54	1.93	1.5	0.39	1

"XX" in item code denotes Finish ID.

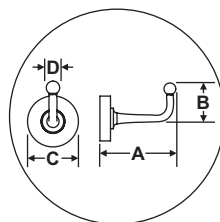

FIG. 1

CSK Phillips Flat Head #6x19.

How to Order

HK.1048.64.5.4



Heathcote Hook Finish Options

Base Material : Brass	Standard Finishes (2-3 Weeks Delivery)					
						
Bright Chrome (Finish ID:2)	Brush Nickel (Finish ID:3)	Aged Brass (Finish ID:4)	Unlacquered Polished Brass (Finish ID:7U)	Polished Nickel (Finish ID:8)	Satin Brass (Finish ID:13)	
Base Material : Brass	Custom Finishes (3-4 Weeks Delivery)*					
						
Lacquered Polished Brass (Finish ID:7L)	Matte Black (Finish ID:19)	Split Black and Satin Brass with Satin Brass Back Plate (Finish ID:49A)	Split Black and Satin Brass with Black Back Plate (Finish ID:49B)	Split Black and Chrome with Chrome Back Plate (Finish ID:59A)	Split Black and Chrome with Black Back Plate (Finish ID:59B)	Graphite (Finish ID:61)
						
Titanium (Finish ID:79)	Ombre (Finish ID:92)					

- Custom finishes cannot be returned or refunded. We are unable to accept cancellations for custom finish order unless within 48 hours of the order being placed.
- We have uniform pricing for all non-hammered finishes listed above as long as base material and size is same.
- Contact us for customized finishes, refer pages F1, F2, F3 & F4 for finish glossary.

Heathcote Hook Split Finish

HK.1048.XX.XX

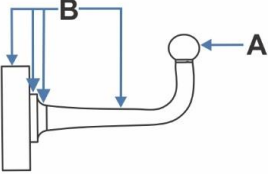
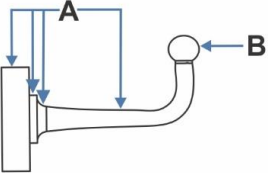
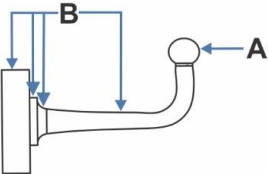
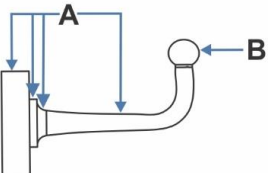
FINISH CODE (XX)	FINISH NAME	LINE DRAWING	A	B
HK.1048.XX.49A	Split Black and Satin Brass with Satin Brass Back Plate		Matte Black	Satin Brass
HK.1048.XX.49B	Split Black and Satin Brass with Black Back Plate		Matte Black	Satin Brass
HK.1048.XX.59A	Split Black and chrome with chrome back plate		Matte Black	Bright Chrome
HK.1048.XX.59B	Split Black and chrome With Black back plate		Matte Black	Bright Chrome