



Polished Nickel (Finish ID : 8)

BEAULIEU CUP PULL

“Form and function complemented by a clean and defined stepped edge detail well reflect different colour accents.”

	Item Code	Size (mm & Inches)	Material	Size (Inches)				Fig.
				A	B	C	D	
1	CP.520.96.XX	96mm (3.78")	Brass	5.2	1.65	3.78	1.14	1
2	CP.520.192.XX	192mm (7.56")	Brass	9.06	1.65	7.56	1.14	1
3	CP.520.96.XX	96mm (3.78")	Bronze	5.2	1.65	3.78	1.14	1
4	CP.520.192.XX	192mm (7.56")	Bronze	9.06	1.65	7.56	1.14	1
5	CP.520.96.XX	96mm (3.78")	Cast Iron	5.2	1.65	3.78	1.14	1
6	CP.520.192.XX	192mm (7.56")	Cast Iron	9.06	1.65	7.56	1.14	1

"XX" in item code denotes Finish ID.

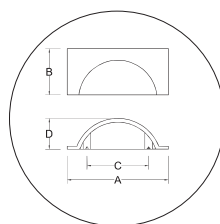

FIG. 1

This product is Supplied with M4x25mm screws.
This product is Supplied with M4x45mm break off screws.

How to Order

CP.520.96.8

CUP PULL STYLE : BEAULIEU SIZE : CC 96MM FINISH ID : 8

Beaulieu Cup Pull Finish Options

Base Material : Cast Iron Custom Finishes (3-4 Weeks Delivery)*	
	Pewter (Finish ID:1)
Base Material : Brass Standard Finishes (2-3 Weeks Delivery)	
	Bright Chrome (Finish ID:2)
	Brush Nickel (Finish ID:3)
	Aged Brass (Finish ID:4)
	Unlacquered Polished Brass (Finish ID:7U)
	Polished Nickel (Finish ID:8)
	Satin Brass (Finish ID:13)
	Lacquered Polished Brass (Finish ID:7L)
	Matte Black (Finish ID:19)
	Graphite (Finish ID:61)
	Ombre (Finish ID:92)
	Brush Chrome (Finish ID:95)
Base Material : Bronze Custom Finishes (3-4 Weeks Delivery)*	
	Silicon Bronze Light (Finish ID:53)
	Silicon Bronze Dark (Finish ID:53D)
	White Bronze (Finish ID:54)

- Custom finishes cannot be returned or refunded. We are unable to accept cancellations for custom finish order unless within 48 hours of the order being placed.
- We have uniform pricing for all non-hammered finishes listed above as long as base material and size is same.
- Contact us for customized finishes, refer pages F1, F2, F3 & F4 for finish glossary.