



Polished Nickel (Finish ID:8)

BREU APPLIANCE PULL

	Item Code	Size (mm & Inches)	Material	Size (Inches)				Fig.
				A	B	C	D	
1	APL.860.12".XX	304.8mm (12")	Brass	12.35	2.92	12	1.46	1
2	APL.860.14".XX	355.6mm (14")	Brass	14.35	2.92	14	1.46	1
3	APL.860.16".XX	406.4mm (16")	Brass	16.35	2.92	16	1.46	1

"XX" in item code denotes Finish ID.

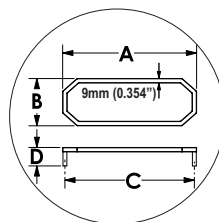
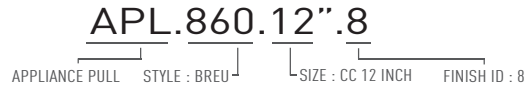

FIG. 1

This product is Supplied with M4x25mm screws.
This product is Supplied with M4x45mm break off screws.

How to Order



Breu Appliance Pull Finish Options

Base Material : Brass	Standard Finishes (2-3 Weeks Delivery)				
 Bright Chrome (Finish ID:2)	 Brush Nickel (Finish ID:3)	 Aged Brass (Finish ID:4)	 Unlacquered Polished Brass (Finish ID:7U)	 Polished Nickel (Finish ID:8)	 Satin Brass (Finish ID:13)
Base Material : Brass	Custom Finishes (3-4 Weeks Delivery)*				
 Lacquered Polished Brass (Finish ID:7L)	 Matte Black (Finish ID:19)	 White Epoxy (Finish ID:42)	 Graphite (Finish ID:61)	 Titanium (Finish ID:79)	 Brush Chrome (Finish ID:95)

- Custom finishes cannot be returned or refunded. We are unable to accept cancellations for custom finish order unless within 48 hours of the order being placed.
- We have uniform pricing for all non-hammered finishes listed above as long as base material and size is same.
- Contact us for customized finishes, refer pages F1, F2, F3 & F4 for finish glossary.
- Backplate options refer page ABP1-1 to ABP3-1.