

Satin Brass (Finish ID : 13)

WRIGHT PERLA KNOB

“The Taj Mahal is a universally revered architectural masterpiece of world heritage, the bevelled geometric shape of the base of the Taj is the inspiration behind Wright Perla.”

	Item Code	Size (mm & Inches)	Material	Size (Inches)				Fig.
				A	B	C	D	
1	KNB.692.25.XX	25mm (0.98")	Brass	1.54	0.98	1.3	2.5	1
2	KNB.692.30.XX	30mm (1.18")	Brass	1.72	1.18	1.3	2.5	1

“XX” in item code denotes Finish ID.

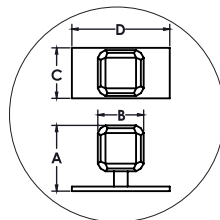
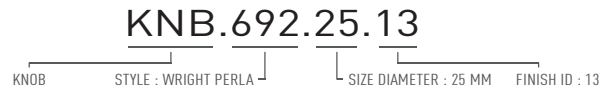

FIG. 1

This product is Supplied with M4x30mm screws.
This product is Supplied with M4x45mm break off screws.

How to Order



Wright Perla Knob Finish Options

Base Material : Brass		Standard Finishes (2-3 Weeks Delivery)			
					
Bright Chrome (Finish ID:2)	Brush Nickel (Finish ID:3)	Aged Brass (Finish ID:4)	Unlacquered Polished Brass (Finish ID:7U)	Polished Nickel (Finish ID:8)	Satin Brass (Finish ID:13)
Base Material : Brass		Custom Finishes (3-4 Weeks Delivery)*			
					
Lacquered Polished Brass (Finish ID:7L)	Matte Black (Finish ID:19)	Titanium (Finish 79)	Brush Chrome (Finish ID:95)		

- Custom finishes cannot be returned or refunded. We are unable to accept cancellations for custom finish order unless within 48 hours of the order being placed.
- We have uniform pricing for all non-hammered finishes listed above as long as base material and size is same.
- Contact us for customized finishes, refer pages F1, F2, F3 & F4 for finish glossary.
- Backplate options refer page KBP1-1 to KBP14-1.